

**DESCRIPTION**

**GEFCO SE147-Series Fan Jets** are made of cast bronze with female pipe thread as indicated. Standard nozzle slot is approximately 0.156" x 3.0". Overall spray effect in horizontal position is that of a 90 degree arc. Vertical spray effect has a flat top. Angular spray effects vary in arc by position of inclination.

This type of jet is best mounted upon a GEFCO SE138-Series swivel union of same or larger pipe size when used in other than vertical position. For vertical position GEFCO SE137-Series adjustment flanges of same pipe size are to be used. For so called water walls, align each vertically mounted jet approximately 5 degrees off the mounted line of sprays, so that each jet sprays slightly past the other. For best performances in the lower, solid water skin spray effect; feed jets with nonturbulent water.

A GEFCO Select #SE137-Series Adjustment Flange is designed to correct the vertical adjustment of sprays up to 5 degrees off of vertical, for larger adjustment use a GEFCO Select #SE138-Series Swivel Union (both #SE137-Series and #SE138-Series can be ordered separately).

The GEFCO Select #SE147 Series Fan Jet can be installed on a GEFCO #PE109-Series Slab Penetration which will provide a rigid non-corrosive, waterproofing penetration. The Jet can also be mounted on a spray pod, spray ring, spray bar or a spray arc.

When specifying, please use the following suffix to ensure the proper fitting is provided:

- GEFCO Select #SE147-XX Fan Jet:
  - 07 3/4" female threaded connection
  - 10 1" female threaded connection

**TYPICAL SPECIFICATIONS:**

- \* **GEFCO Select #SE147-XX Fan Jet:**
  - Single piece
  - made of machined cast bronze.
  - XX NPT Connection (Please specify)

**ADDITIONAL INFORMATION:**

- Suction Straining required to be: MAX. 0.125".

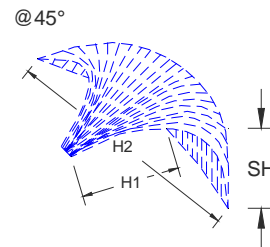
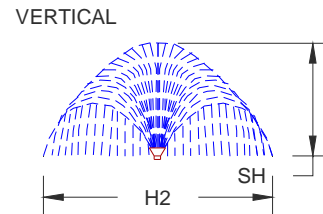
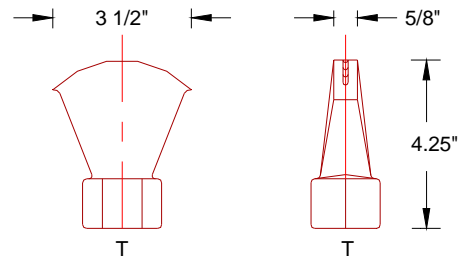

Vertical Performance

SH	H2	GPM	FH
2'	10'	12	4
3'	15'	16	6
4'	21'	20	7
5'	27'	23	9

Performance @ 45°

H1	H2	SH	GPM	FH
Ft.	Ft.	Ft.		
2'	5'	1'-1"	5	7
3'	9'	1'-2"	9	9
4'	12'	2'-6"	12	10
5'	15'	3'-2"	15	15
6'	18'	3'-11"	18	17
7'	21'	4'-6"	20	18

**IMPORTANT REQUIREMENT**

Designers and Engineers shall be responsible for the accuracy of system flow rates and especially system head loss requirements. Stated flows and head pressure requirements for any listed spray height are required AT THE NOZZLE. Extrapolations for unlisted spray heights are at the sole responsibility of the Designers and/or Engineers.

**IMPORTANT**

Dimensions, Manufacturers and/or Materials subject to change without notice